

Instructions for Thermal Decal Application

Preparation of Surface

1. Prior to application, wipe surface clean of any grease, oil, dust or residue using water and a lint free cloth. **Do not use a cleaning product.** (Most common glass cleaning products are oil or alcohol based and leave behind residue that will lessen adhesive tack.)
2. For best results, decals should be applied at temperatures above 60° degrees Fahrenheit.

Application

Step 1

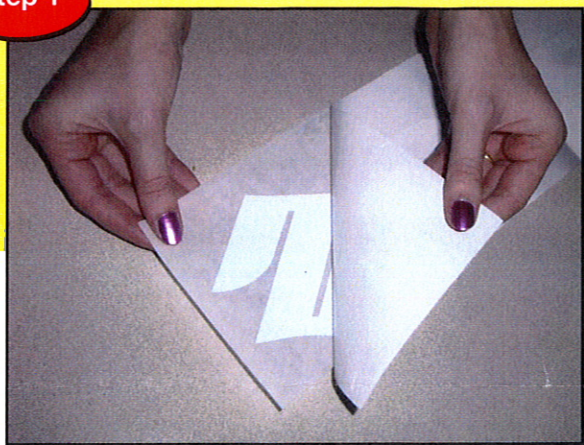

Lay the decal print side down on a flat surface and carefully remove the heavy backing paper.

Step 2



Position the decal on the surface and press down on one edge with your thumb. Hold the remainder of the decal tight and slightly away from the surface with your other hand.

Step 3



Rub the decal down firmly with your hand or a burnisher (available at art supply stores). Re-rub the entire decal by hand or burnisher making sure all portions are firmly applied.

Step 4



Starting at one corner, remove the application tape or pre-mask by **slowly** and **carefully** peeling it down and back flat against itself. If a portion of the decal does not adhere, burnish or firmly rub that area again to ensure adhesion and continue removing the pre-mask.